

Ready Mix Midweight[®] Joint Compound

Panel Rey[®] offers the multipurpose Midweight Ready Mix especially designed for professional installers that require an easy and practical application with appropriate adherence to substrate. This product has been formulated to provide an optimal performance with characteristics highly appreciated by installers who are looking for ways to reduce the application time, as well as achieving excellent adherence and low shrinkage. This product is ideal for projects that demand high quality fast work.

The compound is made of vinyl adhesives and other additives: it can be applied directly from the packaging, manually or with mechanical equipment, and meets the ASTM C-475 Standard in accordance to the ASTM C-474 Standard procedures. For your safety, Panel Rey[®] products do not contain asbestos.

Midweight Ready Mix Compound ensures adherence to substrate, promotes fast drying and it is easy to apply. Its properties make it ideal for joint treatment and retouching works or for texturing walls or ceilings. It guarantees protection against the growth of microorganisms during its shelf life and after its application, following all of the basic use and installation measures.

Recommended applications:

- Adherence of joint tape (1st and 2nd application)
 - Treatment of accessories like corner beads and trims
 - Retouching of cracks, screws and nail heads
 - Inside texturing
- **Coverage:** 1.8 m²/kg. (Depending on the desired application).
- **Availability:** Box of 19.0 kg (3.5 gal)



Make the best compound choice of the Panel Rey® family

If you are looking for:	Joint tape (1st and 2nd coat)	Refilling metal or PVC accessories	Joint finishing and accessories	Refining nails and screws	Texturing	Finish the work quickly
Quality you need:	Excellent adherence	High viscosity	Smoothness and easy sanding	Smoothness and low shrinking	Good shape and firm coat	Controlled drying
Standard	★ ★ ★	✓ ✓	✓	✓	✓ ✓	✓
Standard Plus	✓ ✓	✓ ✓	★ ★ ★	✓ ✓	✓ ✓	✓ ✓
Midweight	★ ★ ★	★ ★ ★	✓ ✓	✓ ✓	✓ ✓	✓ ✓
Ultima Light	✓ ✓	✓ ✓	★ ★ ★	★ ★ ★	✓ ✓	✓ ✓
Easy Set*	★ ★ ★	✓ ✓	✓	★ ★ ★	✗	★ ★ ★
Spray Texture*	✗	✗	✗	✗	★ ★ ★	✗

* See Technical Information Sheets to check the individual specifications and specialized applications of products for treating joints with controlled drying (Easy Set) and for texturing (Ceiling Texture and Spray Texture).

References:

- ✓ Acceptable performance for this application, but you can find a better Panel Rey® product.
- ✓ ✓ Very good performance for this application. We recommend using it.
- ★ ★ ★ Excellent performance for this application. You will not find a better product.
- ✗ Do not use for this application.

Comparative characteristics of multipurpose ready mix products

PRODUCT	Standard	Standard Plus	Midweight	Ultima Light
Net mixture per box of 3.5 gal (kg)	21.8	21.8	19.0	17.4
Ready Mix Density (kg/L)	1.55	1.70	1.67	1.35
Viscosity @ 25°C (cP/1000)	148	123	175	121
% Adhesion with Panel Rey® tape	96	98	98	97
% of shrinkage	17	16	13	16

This information does not represent product specifications. It is only a comparison reference. See ASTM C-475 Standard to verify international specifications that apply to the product.

General application

Cover drywall joint with a thin coat of prepared ready mix and soak the joint tape, leaving a coat of approximately 1/32" (1 mm) under the tape. Allow a drying time that may vary based on weather conditions and type of compound.

Let dry before applying a second coat, which will look to cover 2" (5 cm) at each side of the ends of the first application. Again, let dry and lightly sand the area where the compound was applied. Finally, apply a third coat covering 2" (5 cm) more than the last coat. Slightly sand, preferably with damp sandpaper for higher quality in the finishing and lower breathable dust production.

Finish covering all head nails, screws, corner beads and trims covering approximately 15 cm around each accessory. Review the finishing level recommendations made by the Gypsum Association GA-214-97, or review a technical summary provided by Panel Rey® regarding the Recommended Finishing Levels.

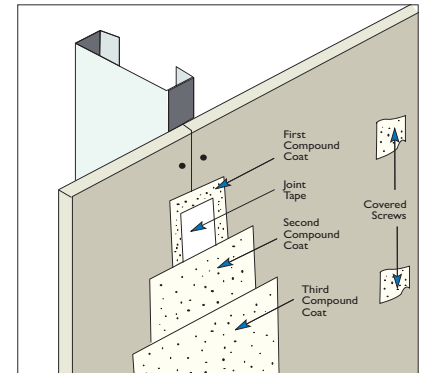

All surfaces must be dry, clean and free of grease or dust, since this could prevent a proper adherence to the substrate. Use clean water to thin and mix products. Make sure temperature of the ready mix, the environment and surface of application exceed 10° C and keep proper ventilation in the work area, which eliminates the excess of moisture.

For more information contact us:

Customer Service USA
1 800 862 9022

Phone
+52 (81) 8345-0055

E-mail
contact.us@gpromax.com

Web Site
www.panelrey.com

Panel Rey S.A.
Serafin Peña #938 Sur Col. Centro
Z.C. 64000 Monterrey, N.L.

We recommend the application of seals to balance the absorption of paint between the surface of the compound and the drywall paper. This product has a six-month warranty, effective from the date of manufacture, provided it has been stored under normal conditions. Do not stow more than two platforms high.

Warnings

Avoid dust with damp sanding. Use a mask and safety goggles. Dust resulting from sanding may irritate eyes, nose or throat. In the event of visual contact, thoroughly wash with water for 15 minutes until all particles are removed. If irritation persists, get medical attention. Do not ingest this product. KEEP OUT OF THE REACH OF CHILDREN.

